

CRH1822

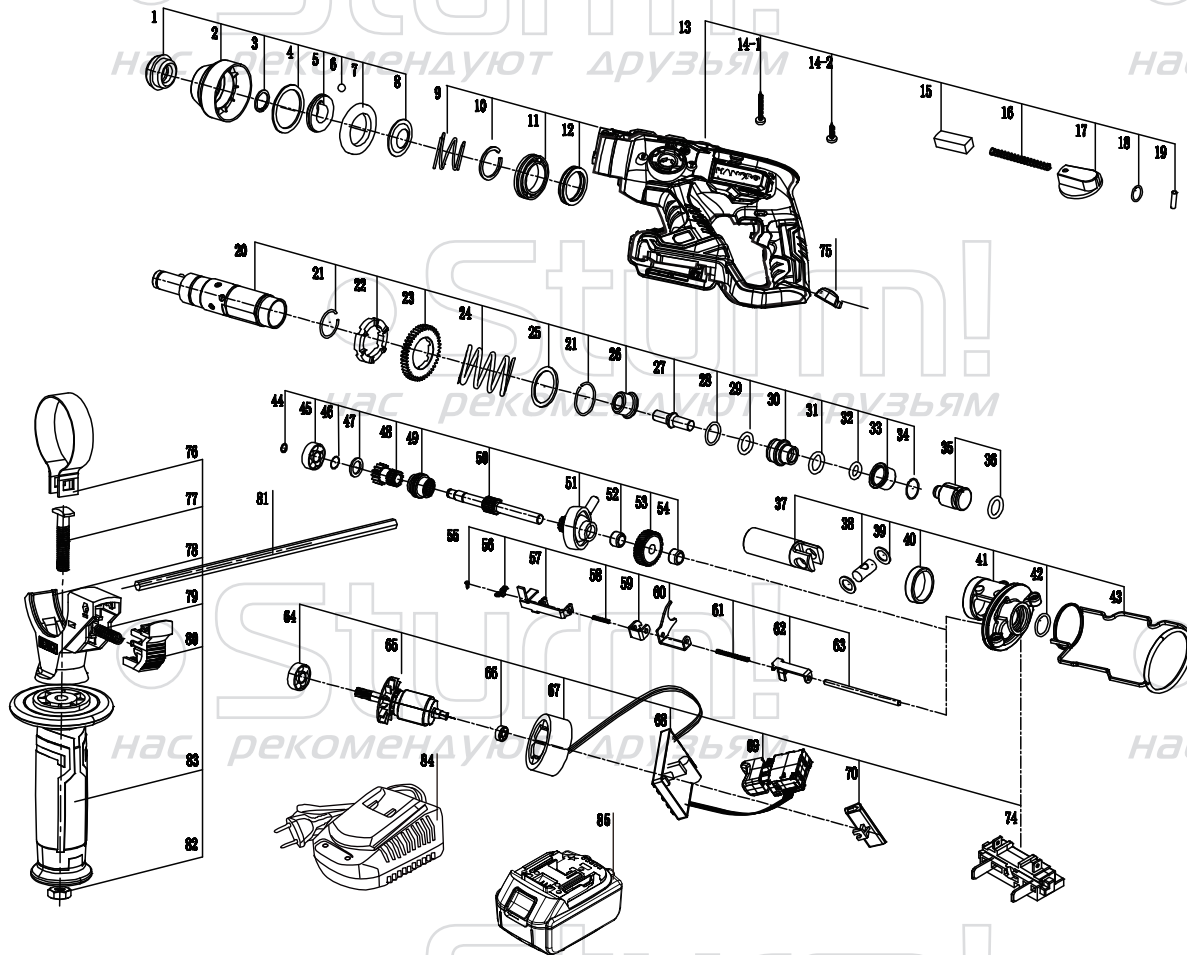

NO.	DESCRIPTION	SPEC.	NO.	DESCRIPTION	SPEC.
1	DUSTPROOF CAP		42	O-RING	
2	PROTECTION SLEEVE		43	SEALING RING	
3	CIRCLIP	Φ14.8	44	CIRCLIP	Φ7
4	WASHER	Φ24.8×Φ30.6×1	45	BEARING	627RS
5	PROTECTION SLEEVE WASHER		46	CIRCLIP	Φ8
6	STEEL BALL	Φ7.1	47	MIDDLE GEAR WASHER	
7	WASHER		48	MIDDLE GEAR	
8	SPRING SEAT		49	CLUTCH DISK 2	
9	SPRING		50	MIDDLE SHAFT	
10	CIRCLIP	Φ25	51	ROCKER BEARING	
11	BEARING	6805RS	52	NEEDLE BEARING	HK081117
12	OIL SEAL		53	BEVEL GEAR	
13	HOUSING		54	NEEDLE BEARING	HK0808
14-1	SCREW	ST4X24	55	SCREW	ST3X14
14-2	SCREW	ST4X16	56	PRESS PLATE	
15	LOCKING BUTTON		57	SHIFTING GEAR UNIT 1	
16	SPRING		58	SPRING	
17	SELECTOR KNOB		59	SHIFTING GEAR UNIT 2	
18	O-RING		60	SHIFTING GEAR UNIT 3	
19	PIN OF KNOB		61	SPRING	
20	ROTARY SLEEVE		62	SHIFTING GEAR UNIT 4	
21	CIRCLIP	Φ1.6X28	63	FUNCTION SWITCHING SHAFT	
22	CLUTCH DISK 1		64	BEARING	608RZ
23	BIG GEAR		65	ROTOR	
24	SPRING		66	BEARING	626Z
25	WASHER	Φ10.3×Φ49×1	67	STATOR	
26	HAMMER ROD FIXED SLEEVE		68	MOTOR PCB	
27	HAMMER ROD		69	SWITCH	
28	O-RING		70	PUSH ROD	
29	O-RING		74	BATTERY PACK CONNECTOR	
30	GUIDE BUSHING		75	LAMP COVER	
31	O-RING		76	CLAMPING BAND	
32	O-RING		77	T-BOLT	
33	FIXED SLEEVE		78	CLAMP HOLDER	
34	CIRCLIP	Φ1.6X24.2	79	SPRING	
35	PISTON		80	DEPTH RULER LOCK	
36	O-RING		81	DEPTH RULER	
37	CYLINDER		82	NUT	M8
38	CYLINDER PIN		83	AUXILIARY HANDLE	
39	CYLINDER PIN WASHER		84	BATTERY	
40	BUSHING		85	CHARGER	
41	BRACKET				